

fischer 

DuoBlade.
The self-drilling
plasterboard plug for
fast installation.



DuoBlade.

The self-drilling plasterboard plug for fast and easy installation.

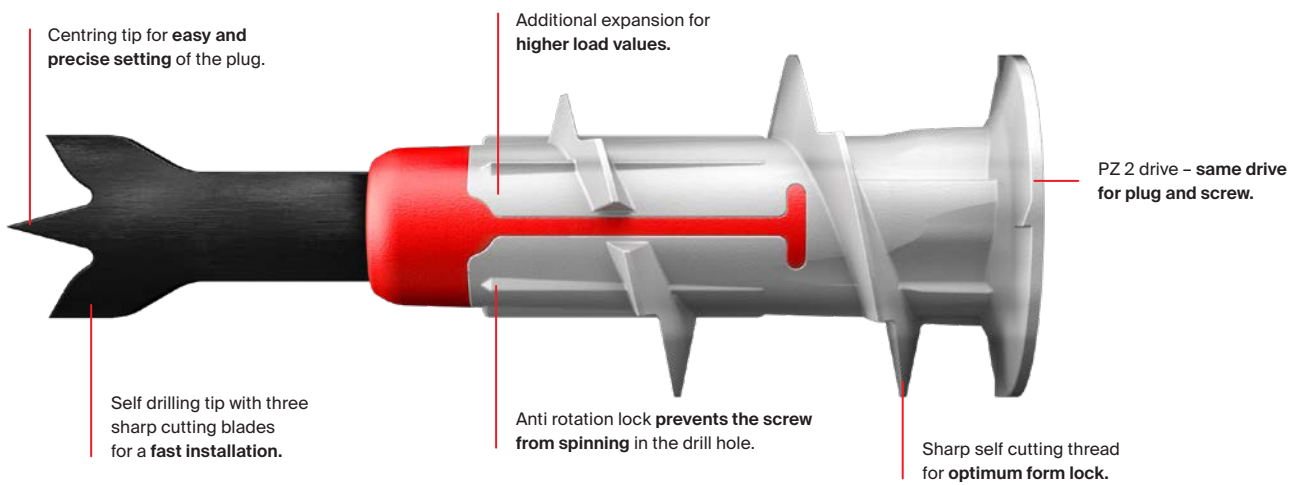

Recommendation

Suitable for building materials, such as

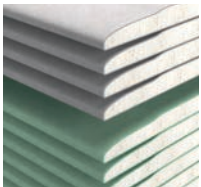

Gypsum plasterboards

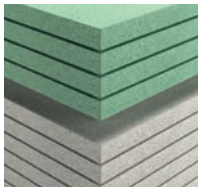

Gypsum fibreboards

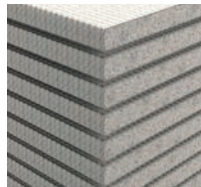

Lightweight cement boards

Features



Advantages, Functioning and installation.

Your advantages at a glance

- An innovative product of the fischer DuoLine with intelligent combinations for more power and more intelligence.
- The self-drilling fischer DuoBlade allows fast and easy installation in gypsum plasterboard and gypsum fibreboard.
- The black metal tip guarantees simple and safe installation.
- High torque when anchor is installed for the feelgood-factor and an optimum feeling when setting.

Functioning

- The fischer DuoBlade is suitable for pre-positioned installation.
- The metal tip for better heat-resistant and cutting characteristics. Especially in double-layered plasterboard.
- The fischer DuoBlade can be used with wood, metal and chipboard screws of \varnothing 4.0 to \varnothing 5.0 mm.
- In gypsum fibreboard, pre-drilling with a drill \varnothing 8mm is recommended.

Installation in panel building materials

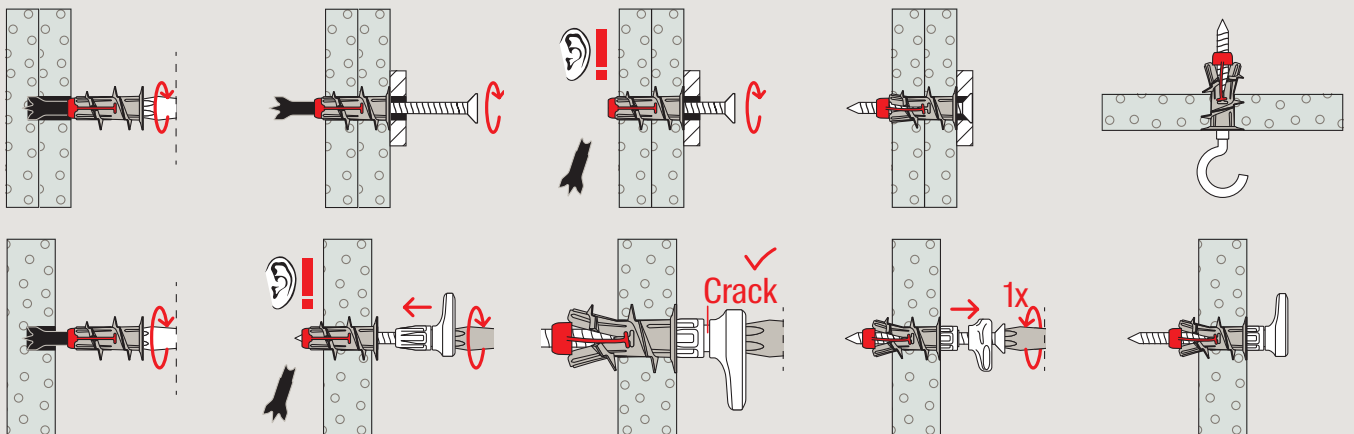

Applications



Clothes hooks



Mirrors



Lamps



Smoke detectors



Pictures

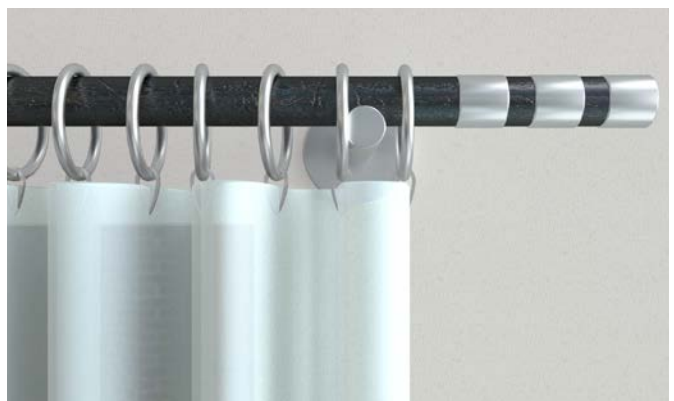

Curtain rods

EasyHook.
Turn screws into
hooks.



Assortment and Loads

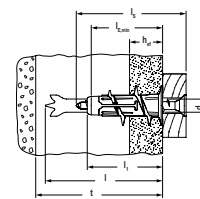

DuoBlade assortment



Item	Art.-No.	Min. thickness to first supporting layer t [mm]	Anchor length l [mm]	Anchor length without drill tip l ₁ [mm]	Anchorage depth h _{ef} [mm]	Min. bolt penetration l _{E, min} [mm]	Screw d _s / d _s x l _s [mm]	Drive t _{fix} [mm]	Sales unit [pcs]
DuoBlade	545675	50	44	29	9.5 - 25	28	4 - 5	–	50
DuoBlade S	545676 ¹⁾	50	44	29	9.5 - 25	28	4.5 x 40	PZ2	25
DuoBlade K NV	545683	50	44	29	9.5 - 25	28	4 - 5	–	10
DuoBlade S K NV	545684 ¹⁾	50	44	29	9.5 - 25	28	4.5 x 40	PZ2	6
DuoBlade WH K NV	545685 ²⁾	50	44	29	9.5 - 25	28	4.2 x 40	–	6
DuoBlade RH K NV	545686 ³⁾	50	44	29	9.5 - 25	28	4.0 x 46	–	6

¹⁾ DuoBlade S - with chipboard screw countersunk head

²⁾ DuoBlade WH - with screw with angle hook

³⁾ DuoBlade RH - with screw with round hook

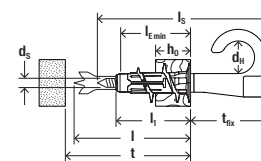

EasyHook Assortment



EasyHook Angle DuoBlade

EasyHook Round DuoBlade

Item	Art.-No.	Drill-diameter d _o [mm]	Minimum Drill hole depth h _{min} [mm]	Minimum Board thickness [mm]	Minimum screw-in depth [mm]	Plug length l = h _{ef} [mm]	Plug screw d _s x l _s [mm]	Diameter hook hole d _H [mm]	Drive	Wall distance t _{fix} [mm]	Content Blister
EasyHook Angle DuoBlade	557919	–	–	9.5	28	44	4.0 x 50	–	PZ 2	4.0 - 9.0	6
EasyHook Round DuoBlade	557920	–	–	9.5	28	44	4.0 x 70	–	PZ 2	24 - 28	6

Plasterboard plug DuoBlade

Highest recommended loads ¹⁾ for a single anchor. The given loads are valid for chipboard screws with the specified diameter.

Type		DuoBlade
Chipboard screw	[mm]	4.5 - 5.0
Recommended loads in the respective base material F _{empf} ²⁾		
Gypsum plasterboard	9.5 mm	[kN] 0.08
Gypsum plasterboard	12.5 mm	[kN] 0.10
Gypsum plasterboard (e.g. Knauf Diamant Platte or Rigips Die Harte)	12.5 mm	[kN] 0.18
Gypsum plasterboard	2x 12.5 mm	[kN] 0.20
Lightweight cement board	12.5 mm	[kN] 0.08
Gypsum fibreboard	12.5 mm	[kN] 0.34

¹⁾ Required safety factors are considered.

²⁾ Valid for tensile load, shear load and oblique load under any angle.



DuoLine.

Intelligent combination for more
Power and more Intelligence.

Dealer:

www.fischer-international.com



fischer stands for

Fixing Systems
Automotive
fischertechnik
Consulting
Electronic Solutions

fischerwerke GmbH & Co. KG
Klaus-Fischer-Straße 1 · 72178 Waldachtal
Germany
T +49 7443 12 - 0
www.fischer-international.com · info@fischer.de
