

Ana-Quick fitting, IP68, nickel plated brass



ANA-QUICK NICKEL PLATED BRASS FITTINGS

The nickel plated brass Ana-Quick fitting fits all types of Ana-Quick conduit. The Ana-Quick fitting is easy to connect and due to the integrated release clips also simple to disconnect if needed. Due to the fact that not only the thread but the complete housing is nickel plated brass, this robust IP 68 fitting is suitable for applications with high technical requirements.

Material & Construction:

Construction: 1 piece fitting with integrated release clip and internal seal.

Material: Fitting is made of nickel plated brass, clips are made of Polyamide PA6 (UL-94 V2) and internal seal is TPE (alle materials are completely halogen free).

Temperature: -40°C till +120°C continuous.

Protection class: IP 68 (dust-proof, liquid-tight).

Colour: Metal

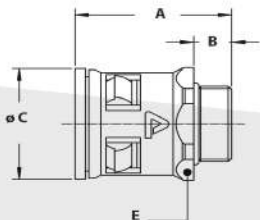

ISO straight fitting, male, nickel plated brass



THREAD ISO	ANA-QUICK SIZE (DN)	MIN. INTERNAL BORE (MM)	DIMENSIONS IN MM					STANDARD PACKAGE	ARTICLE NUMBER	APPROX. WEIGHT (KG/100)
			A	B	C	E	F			
M12 x 1,5	7,5	6,4	34	10	17	16	-	10	652.012.0	1,5
M16 x 1,5	7,5	6,4	34	10	17	20	-	10	652.013.0	2,0
M16 x 1,5	10	9,5	36	10	20	20	-	10	652.015.0	2,0
M20 x 1,5	10	9,5	36	10	20	24	-	10	652.014.0	3,0
M16 x 1,5	12	11,4	38	10	23	21	-	10	652.016.0	2,2
M20 x 1,5	12	11,4	38	10	23	24	-	10	652.017.0	2,9
M20 x 1,5	17	15,4	42	10	29	27	-	10	652.020.0	3,5
M25 x 1,5	17	15,4	43	11	29	29	-	5	652.022.0	4,5
M25 x 1,5	23	20,4	45	11	37	35	-	5	652.025.0	5,3
M32 x 1,5	23	20,4	47	13	37	36	-	5	652.028.0	6,3
M32 x 1,5	29	26,4	51	13	44	44	-	5	652.032.0	9,7
M40 x 1,5	29	26,4	51	13	44	44	-	2	652.035.0	10,3
M40 x 1,5	37	34,9	53	13	52	52	-	2	652.040.0	14,4
M50 x 1,5	37	34,9	54	14	52	55	-	2	652.045.0	17,8
M50 x 1,5	50	43,9	60	14	64	64	-	2	652.050.0	22,7
M63 x 1,5	50	45,9	60	14	64	68	-	2	652.060.0	26,9